

CONFERENCE PROGRAM

AUGUST 27-29, 2019

Tokyo, Japan

ISEPSS

International Symposium on Education, Psychology and Social Sciences

ISBN: 978-986-89844-4-8

APCMB

Asia-Pacific Conference on Management and Business

ISBN: 978-986-89844-0-0

Content

International Committees	4
Tuesday at a Glance	8
Wednesday at a Glance	9
Thursday at a Glance	10
General Information	11
Presentation Guide	12
Room Schedule	14
Room Schedule	15
Floor Guide	16
Directions & Access	17
Keynote Presentation: Kwun Nam Hui	19
Keynote Presentation: Joseph Lau	20
Wednesday, August 28	22
Parallel Sessions & Poster Sessions	22
Wednesday Session I	23
Wednesday Session I	25
Wednesday Session II	26
Wednesday Session III	28
Thursday, August 29	31
Parallel Sessions & Poster Sessions	31
Thursday Session I	32
Thursday Session I	34
Thursday Session II	35
Thursday Session II	37
Law, Economics II, Finance	37

International Committees

Adeeb Jarrah, United Arab Emirates University, United Arab Emirates

Ahrar Husain, Jamia Millia Islamia, India

Alex Yao Tang, National Cheng Kung University, Taiwan

Ashish Pareek, Maharshi Dayanand Saraswati University, India

Atefeh Ferdosipour, Azad University, Iran

Azidah Abu Ziden, Universiti Sains Malaysia

Azilawati, Nanyang Technological University, Singapore

Aziz Bin Ahmad, University Malaysia Terengganu, Malaysia

B. Suresh Lal, Kakatiya University, India

Badar Alam Iqbal, Aligarh Muslim University, India

Bayram Akarsu, Erciyes University, Turkey

Bor-Tyng Wang, Feng Chia University, Taiwan

Brian Hunt, Mahidol University, Thailand

Cathine G. Scott, Morris College in Sumter, USA

Chen-Yi Lin, National Taichung University of Science and Technology,
Taiwan

Chia-Hwan Chen, National Taipei University of Education, Taiwan

Chia-Ming Chang, National Chia-Yi University, Taiwan

Chib Datta Meghe, Institute of Management Studies, India

Chih-Wei Peng, Taipei Medical University and Hospital, Taiwan

Ching-Yi Tien, I-Shou University, Taiwan

Chi-Ying Chen, Asia University, Taiwan

Concepcion C. Libuit, City University of Pasay, Philippines

Darshan Kaur Narang, University of Rajasthan, India

Dharam Vir Mahajan, CCS University, India

Donald L. Amoroso, Auburn University at Montgomery, USA

Donghun Lee, Sungkyunkwan University, South Korea

Eddy K.W. Li, The Chinese University of Hong Kong, Hong Kong

Edward Hwang, Chung Hua University, Taiwan

Eric Santos Parilla, University of Asia and the Pacific, Philippines

Frank S.C. Tseng, National Kaohsiung First University of Science and
Technology, Taiwan

Funda Varnaci Uzun, Aksaray University, Turkey

Hamzeh Dodeen, United Arab Emirates University, United Arab Emirates

Intan Soliha Binti Ibrahim, Universiti Malaysia Sabah, Malaysia

Irene Guatno Toribio, Philippine Christian University, Philippines
Jalil Safaei, University of Northern British Columbia, Canada
Jamie Halsall, University of Huddersfield, UK
Jeffrey Trambley, Musashino Gakuin University, Japan
Jian-Horng Chen, Chung Shan Medical University, Taiwan
John Christian S. Jardín, Palawan State University, Philippines
John Erinorio Perez, University of the Philippines Los Baños, Philippines
Jonas Chao-Pen Yu, Takming University of Science and Technology, Taiwan
Joseph Lau, The University of Hong Kong, Hong Kong
Joyce Zhou, Emporia State University, USA
Junaid M. Shaikh, Curtin University Sarawak Malaysia, Malaysia
Kaedsiri Jaroenwisan, Silpakorn Univesity, Thailand
Kanokphon Chantanarungpak, Srinakharinwirot University, Thailand
Karen Miranda Fernandez, Imus Institute, Philippines
Karendra Devroop, University of South Africa, South Africa
Kyung Hee Kim, Mokpo National University, South Korea
Kim Sangho, Ritsumeikan Asia Pacific University, Japan
Deok Man Kim, Baekseok University, South Korea
Krishna Govender, AAA School of Advertising, South Africa
Hsiao-Tseng Lin, Meiho University, Taiwan
Linda Oshita, University of Hawaii, USA
Margaret Sanapo, Ritsumeikan University, Japan
Maria Cristina M. De los Santos, Kyungdong University-Global Campus, South Korea
Marie Paz E. Morales, Philippine Normal University, Philippines
Mehryar Nooriafshar, University of Southern Queensland, Australia
Michael Kao, Chang Gung University, Taiwan
Micheal Kon, Aletheia University, Taiwan
Michelle M. Mukherjee, Queensland University of Technology, Australia
Mindy Suzanne Andino, Bloomsburg University, USA
Ming-Chang Chih, National Chung Hsing University, Taiwan
Mingchu Luo, Emporia State University, USA
Mohamad Hafis Amat Simin, University Sultan Zainal Abdin, Malaysia
Mohamed Ahmed El Khouli, Sadat Academy for Management Science, Egypt
Mohamed Hammad Hendy, Beni-Suef University, Egypt
N. S. Ravishankar, Axis Bank, India
Naim Uzun, Aksaray University, Turkey

Nezaket Memmedli, Azerbaijan National Academy of Sciences, Azerbaijan
Ng Woon Lam, Nanyang Technological University, Singapore
Nukshi Esther Imsong, Institution of Psychology Counselling and Educational Research, India
Obydullah Al Marjuk, Independent University, Bangladesh
Ozgul Keles, Aksaray University, Turkey
Prasong Tanpichai, Kasetsart University, Thailand
Ramayah Thurasamy, Universiti Sains Malaysia, Malaysia
Reem Abed Almotaleb Abuiyada, Dhofar University, Palestine
Ricky Ng, Vocational Training Council, Hong Kong
Ronald Griffin, Florida Agricultural & Mechanical University, USA
Rotaru Ioan-Gheorghe, Timotheus Brethren Theological Institute of Bucharest, Romania
Ruby Ann L. Ayo, Bicol University, Philippines
Sadiq Abdulwahed Ahmed Ismail, United Arab Emirates University, United Arab Emirates
Sally dhruva' Stephenson, Frosterburg State University, USA
Shaik. Feroz, Caledonian College of Engineering, Oman
Shiv Prasad, Maharshi Dayanand Saraswati University, India
Shujen Lee, Asia University, Taiwan
Shun-Hsing Chen, Oriental Institute of Technology, Taiwan
Soon Song, Wonkwang University, South Korea
Stacey Jocoy, Texas Tech University, USA
Sunil Kumar, Alliance University, India
T.S.Devaraja, University of Mysore, Hemagangothri Campus, India
Tan Khay Boon, SIM Global Education, Singapore
Theeraphab Phetmalaikul, Srinakharinwirot University, Thailand
Vijayaletchumy Subramaniam, Universitas Putra Malaysia, Malaysia
Wang Yu-Shan, National Kaohsiung First University of Science and Technology, Taiwan
Wei-Cheng Mau, Wichita State University, USA
Yong-Ho Kim, Pukyong National University, South Korea
Yong-Taek Rhim, Namseoul University, South Korea

Special Thanks to Session Chairs

Rahmawati, Universitas Sebelas Maret Surakarta, Indonesia

Marilyn L Baysa, Philippine Public Safety College, Philippines

Kwun Nam Hui, University of Macau, Macau

Karl Wiener, Charles Sturt University, Australia

Edy Supriyono, STIE Bank BPD Central Java, Indonesia

Dorit Maor, Murdoch University, Australia

Muhammad Taufiq Amir, Universitas Bakrie, Indonesia

Paramita Ersan, University of Padjadjaran, Indonesia

August 27, 2019 @ Hotel Sunroute Plaza Shinjuku

Tuesday at a Glance

- 08:30-09:00** **Gathering for Socializing Event (Optional Extra)**
Lobby @ Hotel Sunroute Plaza Shinjuku
- 09:00-18:00** **Socializing Event (Optional Extra)**
- 10:00-12:00** **Conference Welcome Reception | 1st Floor Foyer Area**

August 28, 2019 @ Hotel Sunroute Plaza Shinjuku

Wednesday at a Glance

- 08:30-16:00** **Registration | 1st Floor Foyer Area**
- 09:00-10:30** **Parallel Session I**
- 10:30-10:45** **Tea Break & Networking**
- Keynote Presentations**
- ◆ **Nanomaterials for Energy Storage Devices**
- 10:45-12:15** Kwun Nam Hui, University of Macau
- ◆ **Higher Education in a Transdisciplinary World –
Hong Kong Case**
- Joseph Lau, The Hong Kong Polytechnic University
- 12:15-13:15** **Lunch Break**
- 13:15-14:45** **Parallel Session II**
- 14:30-15:30** **Poster Session I**
- 14:45-15:00** **Tea Break & Networking**
- 15:00-16:30** **Parallel Session III**

August 29, 2019 @ Hotel Sunroute Plaza Shinjuku

Thursday at a Glance

08:30-12:00 **Registration | 1st Floor Foyer Area**

09:00-10:30 **Parallel Session I**

09:30-10:30 **Poster Session II**

10:30-10:45 **Tea Break & Networking**

10:45-12:15 **Parallel Session II**

11:00-12:00 **Poster Session III**

12:15-13:15 **Lunch Break**

General Information

Registration

You will be able to pick up your registration pack and name card at the Conference Registration Desk. The Conference Registration Desk will be situated on the **1st floor** at **Hotel Sunroute Plaza Shinjuku** during the following time:

10:00-12:00, Tuesday, August 27, 2019

08:30-16:00, Wednesday, August 28, 2019

08:30-12:00, Thursday, August 29, 2019

Name Badges

When you check in, you will receive a registration pack, which includes your name badges. Wearing your badge is required for entrance to the sessions. You must wear your badge at all times during the conference.

Refreshment Breaks

Complimentary coffee, tea, water and light snacks will be available during the scheduled coffee breaks.

What to Wear & Bring

Attendees generally wear business casual attire. You may wish to bring a light jacket as meeting rooms are air-conditioned and sometimes cool.

Presentation Guide

Oral Presentations

The time for the Oral Presentation (90 min/ Session)

Number of Presentation	Presentation Time
3	15-25 min. each (+5 min. Q&A)
4	15-18 min. each (+4 min. Q&A)
5	15 min. each (+3 min. Q&A)
6	12 min. each (+3 min. Q&A)
7	11 min. each (+2 min. Q&A)

Presenters are reminded that the time slots should be divided fairly and equally by the number of presentations, and that they should not overrun. The session chair is asked to assume this timekeeping role and to summarize key issues in each topic.

Poster Presentations

The time for the Poster Presentation (50-60 min/Session)

Please stay in the session to the end of it. All poster presenters must bring your poster materials with you in your session time. You can post your poster 10 minutes before your session starts. **Materials Prepared by the**

Presenters:

1. **Home-made Poster(s)**
2. **Material: not limited, can be posted on the canvases**
3. **Recommended Poster Size: 60cm * 120 - 140cm**

Presentation Certificates

Presenters will receive a certificate of presentation from their Session Chair or a member of staff at the end of their session.

Equipment

Oral Presentation:

All presentation rooms are equipped with a screen, an LCD projector and a laptop computer installed with Microsoft PowerPoint. You will be able to insert your USB flash drive into the computer and double check your file in PowerPoint. We recommend that you bring two copies of your presentation in case one fails, and suggest sending yourself the presentation by email as a third and final precaution.

Poster Presentation:

Materials Provided by the Conference Organizer:

1. X-frame display & Base Fabric Canvases (60cm×160cm)
2. Adhesive Tapes, clamps, or clips
3. Our staff on-site will assist you to put up on the poster board with the clips we provide



A Polite Request to All Participants

Participants are request to arrive in a timely fashion for all addresses and refrain from talking amongst themselves and ensure that mobile phones are switched off or set to silent mode during presentations.

Room Schedule

Wednesday, August 28

	Beni	Kaze	Mai
09:00~10:30	Environmental Engineering, Power & Energy Engineering, Civil Engineering	Business & Management I	Education I
10:30~10:45	Tea Break & Networking		
10:45~12:15	Keynote Presentation	-	-
12:15~13:15	Lunch		
13:15~14:45	Business & Management II	Fundamental and Applied Sciences, Computer Engineering and Technology, Information Engineering and Technology	-
14:45~15:00	Tea Break & Networking		Poster Session I
15:00~16:30	Life Sciences, Mechanical Engineering, Biological Engineering Material Science and Engineering	Psychology, Communication	Business & Management, Psychology, Education, Material Science and Engineering I, Chemical Engineering I

Room Schedule

Thursday, August 29

	Beni	Kaze	Mai
09:00~10:30	Business & Management III	Education II	Poster Session II Civil Engineering, Life Science, Biological Engineering, Chemical Engineering II, Computer Engineering and Technology, Mechanical Engineering I
10:30~10:45	Tea Break & Networking		
10:45~12:15	Business & Management IV, Economics I	Law, Economics II, Finance	Poster Session III Material Science & Engineering II, Electrical & Electronic Engineering, Information Engineering & Technology, Fundamental & Applied Sciences, Mechanical Engineering II
12:15~13:15	Lunch		

Floor Guide

Hotel Sunroute Plaza Shinjuku

First Floor | 1F

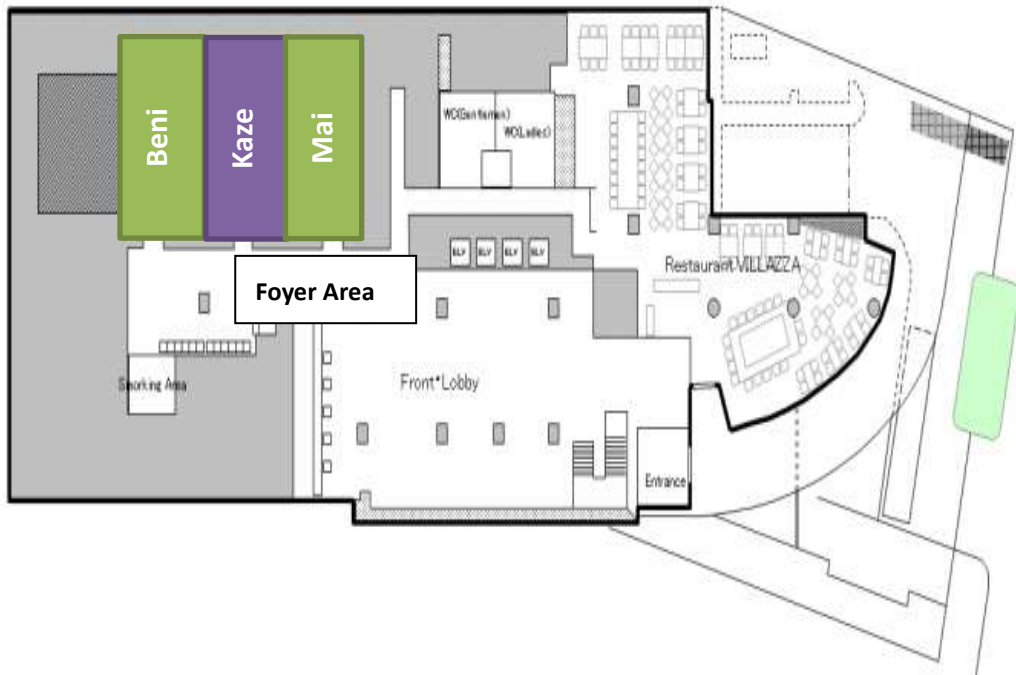

Registration: Foyer Area

Oral Session: Kazi, Beni, Mai

Poster Session: Mai

Lunch: Kazi, Beni, Mai

Tea Break & Networking: Foyer Area

Directions & Access

By Train

Train to **JR Shinjuku Station** or **Toei Oedo Line Shijuku Station** or **Keio Line Shinjuku Station**

South Gate

1. 3 min walk.
2. Please exit South Exit and take right.
3. Keep walking until you find the first intersection (Nishi Shinjuku Itchome) and turn left.
4. Walk on straight, pass McDonald's and keep on walking for about 50m.
5. Finally you will see our hotel on the right side.

A1 Exit

1. 1 min walk.
2. After going out of the exit, our hotel is just on the right.

A4 Exit

1. Lumine Exit | 3min walk.
2. Take left after going out of the exit, you will see Nishi Shinjuku Itchome intersection.
3. Please go round the corner of Yoshinoya to the left.
4. After walking for about 50m, you will find our hotel on the right.

Koshu-kaido Gate

1. 3min walk.
2. Please take left at the exit.
3. Walk under the pedestrian bridge and keep straight on.
4. Turn left at the first intersection, pass McDonald's, and keep on walking for about 50m.
5. Finally you will see our hotel on the right side of the street.

From Haneda Airport (about 50-60 mins)

a) Haneda Airport Station → (Tokyo Monorail) → Tennozu Isle Station → (Direct operation of Rinkai Line with JR Saikyo Line) → Shinjuku Station → (On foot) → Hotel Sunroute Plaza Shinjuku

b) Haneda Airport Station → (Keikyu Line) → Shinagawa Station → (JR Yamanote Line) → Shinjuku Station → (On foot) → Hotel Sunroute Plaza Shinjuku

From Narita International Airport (about 80 mins)

Narita International Airport → (Narita Express) → Shinjuku Station → (On foot) → Hotel Sunroute Plaza Shinjuku

By Bus

International travelers can easily arrive at one of two Tokyo airports near Hotel Sunroute Plaza Shinjuku, the Narita International Airport and the Tokyo International Airport (Haneda), via shuttle bus services.

a) Haneda Airport (60min)

b) Narita International Airport (120min)

By Taxi

From Haneda Airport (about 60 mins / about 10,000 JPY)

From Narita Airport (about 120 mins / about 30,000 JPY)

Keynote Presentation: Kwun Nam Hui

Nanomaterials for Energy Storage Devices

Wednesday, August 28 | 10:45-12:15 | Beni

With the rapid development of electronic technology, wearable and flexible devices such as roll-up displays, biomedical sensors, and wearable devices, have drawn considerable attention. Developing high energy density flexible supercapacitors hold the promise to provide a safe, fast charge/discharge rate, and long-life flexible energy storage devices. However, the intrinsically poor electrical conductivity and an insufficient number of electrochemically active sites of transition-metal oxides hamper their wide application in energy storage devices. Accordingly, hybridizing pseudocapacitive metal oxide materials with carbon-based materials such as CNT and graphene has become an appealing strategy in increasing the specific capacitance and energy density of film electrodes for flexible supercapacitors. In this talk, the speaker will present his recent work in the development and application of nanomaterials for flexible supercapacitors. Several strategies, including the morphology control, core/shell architecture, and defect engineering, will be discussed to improve the electron transports, electrolyte ions diffusion kinetics, and electrical conductivity of electrodes. In particular, the heteroatoms doping approach is demonstrated to lower the diffusion barrier of electrolyte ions in intercalated supercapacitors. Experimental analyses and theoretical calculations reveal that the electronic structure of metal oxides can be efficiently modulated by incorporating heteroatoms and oxygen vacancies, thereby simultaneously reducing the energy band gap and increasing electrical conductivity.



Dr. Kwun Nam HUI is currently an Associate Professor at the Institute of Applied Physics and Materials Engineering, University of Macau, Macau SAR, China. Before this, he was Associate Professor at Pusan National University, Republic of Korea. His current research focuses on the synthesis of hierarchical carbon/graphene materials as well as on the development of 3D hierarchical layered double hydroxide materials as advanced electrode materials for energy storage and conversion applications. He has published more than 150 journal articles with a citation of over 3400 times and an h-index of 37.

Keynote Presentation: Joseph Lau

Education in a Transdisciplinary World:

Hong Kong Case

Wednesday, August 28 | 10:45-12:15 | Beni

Hong Kong higher education stemmed from the late 19th century. Hong Kong has undergone different waves of educational reform in response to the transition of political sovereignty, the alignment with international higher education development, the knowledge economy, societal developments, accountability and globalization. Prior 1st July 1997, Hong Kong was under a colony of the British Empire. To this end, the higher education system was then completely based on the English model. Thanks to globalization, Hong Kong higher education institutions introduced neo-liberal market model. Through marketization and privatization concept, Hong Kong higher education institutions fundamentally changed education policy and governance in higher education sector. Consequently, regional education hub, self-financing tertiary education and quality assurance system arise in a transdisciplinary world. The study provides important insights to educators to explore the ways in developing effective adaptation plans and practice for higher education institutions and other sectors. Academic and managerial implications of the study are also given.



Mr. Lau Yui Yip, Joseph graduated from The Hong Kong Polytechnic University (PolyU) and received a BSc (Hons) in International Shipping and Transport Logistics in 2007. He was placed on the Dean List because of his outstanding academic performance during his bachelor degree studies. He received his Master of Science in International Shipping and Transport Logistics from PolyU in 2009.

Until now, Mr Lau has published more than 130 research papers in international journals and professional magazines, and contributed book, book chapters and presented numerous papers in international conferences. He has collaborated with scholars from more than 20 countries and regions spreading over five continents on research projects. He has also secured over HK\$ 5.7 million research grants. Recently, he has been awarded a Certificate of Appreciation by the Institute of Seatransport in recognition of his outstanding performance on research,

the Best Paper Award in international leading conferences and Dean Award for Outstanding Research-Scholarly Performance by College of Professional and Continuing Education, The Hong Kong Polytechnic University. In addition, he has participated in different consultancy projects with various (inter-)governmental organisations, academic institutions and industrial associations, e.g. Trade and Industry Department, China Communications & Transport Association (CCTA), The Chartered Institute of Logistics and Transport (CILT), the Institute of Seatrtransport, Hong Kong Sea Transport and Logistics Association (HKSTLA), and PolyU. In addition, he has been appointed as Associate, University of Manitoba, Transport Institute, Winnipeg, Manitoba, Canada; Visiting Scholar at East China Normal University; Researcher at Constanta Maritime University. His research interests are Transport History, Maritime Transport, Air Transport, Port Planning, Supply Chain Management, Green Transport, Maritime Law, Public Transport, Maritime Education and Human Geography.

Wednesday, August 28

Parallel Sessions & Poster Sessions

09:00-10:30 | Kaze

Wednesday Session I

Business & Management I

Session Chair: Prof. Rahmawati

APCMB-0016

Potential Brood for Business Activities Cashew Seedings (Case Study in Wonogiri District)

Eko Murniyanto, Universitas Trunojoyo Madura, Indonesia

Endang Siti Rahayu, Universitas Sebelas Maret Surakarta, Indonesia

Rahmawati, Universitas Sebelas Maret Surakarta, Indonesia

Bambang Pujiasmanto, Universitas Sebelas Maret Surakarta, Indonesia

APCMB-0061

Value Added (Value Change) Cashew (Anacardium Occidentale L.) in Wonogiri District, Central Java

Rahmawati, Universitas Sebelas Maret Surakarta, Indonesia

Endang Siti Rahayu, Universitas Sebelas Maret Surakarta, Indonesia

Eka Murniyanto, Universitas Trunojoyo Madura, Indonesia

Ign. Novie Endi Nugroho, Universitas Sebelas Maret Surakarta, Indonesia

APCMB-0071

Exploring the Influencing Factors toward Using the Online Food Delivery Platform

You-Zhen Liu, National Taiwan Normal University, Taiwan

Chin-Yi Fang, National Taiwan Normal University, Taiwan

APCMB-0070

Modeling Wine Enthusiast Data: Wine Score Prediction and Visualization through Machine Learning

Coco Ying, National Taiwan Normal University, Taiwan

Chin-Yi Fang, National Taiwan Normal University, Taiwan

09:00-10:30 | Mai

Wednesday Session I

Education I

Session Chair: Prof. Marilyn L Baysa

ISEPSS-0262

Experiential Learning via Patient Journey and Nursing Students' Preparedness before Their First Clinical Placement in Hong Kong

H. W. Annemarie Cheung, Caritas Medical Centre, Hong Kong

S. M. Leung, Caritas Medical Centre, Hong Kong

ISEPSS-0230

Thai Language Learning and Teaching of the Vietnamese Students in Cross-cultural Communication Contexts

Le Tran Mac Khai, Srinakharinwirot University, Thailand

Supak Mahavarakorn, Srinakharinwirot University, Thailand

ISEPSS-0252

National Jail Management and Penology Training Institute (NJMPTI): Status and Prospects

Marilyn L Baysa, Philippine Public Safety College, Philippines

Joy G De Loyola, National Jail Management and Penology Training Institute, Philippines

ISEPSS-0090

What are the Roles of Host University to Ensure the Quality of Transnational Higher Education?

Yangchun Sun, Dalian University of Technology, China

13:15-14:45 | Beni

Wednesday Session II

Business & Management II

Session Chair: Prof. Kwun Nam Hui

APCMB-0055

Islamic Sustainability Indicators in Creative Companies in Kudus City with the Gusjigang (Nice, Teaching and Trading) Approach

Rahmawati, Universitas Sebelas Maret Surakarta, Indonesia

Dwi Soegiarto, Universitas Sebelas Maret Surakarta, Indonesia

Djuminah, Universitas Sebelas Maret Surakarta, Indonesia

APCMB-0014

Natural Color Batik Crafts Development with Cow Powder in Bantul Yogyakarta

Rahmawati, Universitas Sebelas Maret Surakarta, Indonesia

Soenarto Soenartob, Universitas Negeri Yogyakarta, Indonesia

Fitri Susilowati, Universitas PGRI Yogyakarta, Indonesia

Sarah Rum Handayanid, Universitas Sebelas Maret Surakarta, Indonesia

Ardi Gunardie, Universitas Pasundan, Indonesia

Arum Darmawati, Yogyakarta State University, Indonesia

ISEPSS-0069

Curvilinear Relationship Between Presenteeism and Innovative Behavior: Moderating Role of Supervisory Support

Hsueh-Liang Fan, Soochow University, Taiwan

APCMB-0005

Determining the Industrial Transformation Strategies for the Med-tech Industry Based on the IAA-NRM Approach

I-Ching Fang, National Cheng Kung University, Taiwan

Fong-Chin Su, National Cheng Kung University, Taiwan

Peng-ting Chen, National Cheng Kung University, Taiwan

15:00-16:30 | Kaze

Wednesday Session III

Psychology, Communication

Session Chair: Prof. Karl Wiener

ISEPSS-0227

Academic Bridging Programs, Generational Status, and Academic Self-efficacy: Is the Relationship Working?

Debra Metcalf, Charles Sturt University, Australia

Karl Wiener, Charles Sturt University, Australia

ISEPSS-0208

Exploring the Relation between Karma, Qi, Spirituality, and Subjective Well-Being among People in Taiwan

Inna Reddy Edara, Fu Jen Catholic University, Taiwan

ISEPSS-0080

Emotional Quotient (EQ) Improvement and Stress Reduction by Spiritual Health Care

Wilairat Leeansaksiri, Suranaree University of Technology, Thailand

Chavaboon Dechsukhum, Suranaree University of Technology, Thailand

ISEPSS-0097

War Metaphor to Ritualize the Practice of Skin Whitening? – Revisiting and ‘Researching’ the Analysis of Texts across Different Communication Channels during 2008 and 2012 from 2019

Yi-Jing Lee, Fong Chia University, Taiwan

14:30-15:30 | Mai

Wednesday Poster Session I

Business & Management, Psychology, Education

APCMB-0076

The Mediating Role of Value Co-creation and Continuous Quality Improvement in Supply Chain Collaboration Model on Thai SMEs Performance: A Conceptual Framework

Wasan Sakulkijkarn, Srinakharinwirot University, Thailand

APCMB-0078

Determinants of Corporate Social disclosure and Corporate Social Performance

Chun-Yun Cheng, Soochow University, Taiwan

ISEPSS-0220

How do Character Strengths Enhance Teachers' Career Well-being? A Longitudinal Mediation Analysis

Yingying Hu, Beijing Normal University, China

Xiaochen Zhao, Beijing Normal University, China

Yiming Yang, Beijing Normal University, China

Wenjing Wang, Beijing Normal University, China

ISEPSS-0067

The Effect of Using Music Therapy to Improve the Agitated Behavior of Patients with Bipolar Disorder

Chuan-Jung Kuo, National Cheng Kung University Hospital, Taiwan

Li-Yu Chen, National Cheng Kung University Hospital, Taiwan

ISEPSS-0020

A Action Research on the Promotion of Literacy of Life Education of Teacher Students

Ming-Chang Tsai, National Chiayi University, Taiwan

ISEPSS-0079

Quality of Lives of the Public Health Students Are Dramatically Improved by Attending the New Elective Course

Chavaboon Dechsukhum, Suranaree University of Technology, Thailand

Wilairat Leraanansaksiri, Suranaree University of Technology, Thailand

Thursday, August 29

Parallel Sessions & Poster Sessions

09:00-10:30 | Beni

Thursday Session I

Business & Management III

Session Chair: Prof. Edy Supriyono

APCMB-0006

How of Effect the Board of Commissioners Characteristics, Corporate Social Disclosure to Firm Value? (Empirical Study on non-financial companies in the Indonesia Stock Exchange)

Edy Supriyono, STIE Bank BPD Central Java, Indonesia

Nurmadi Harsa Sumarta, Sebelas Maret University Surakarta, Indonesia

Afda Reza Armashita, Sebelas Maret University Surakarta, Indonesia

Sohidin, Sebelas Maret University Surakarta, Indonesia

Djoko Suhardjanto, Sebelas Maret University Surakarta, Indonesia

APCMB-0067

Edu-Tourism of Weaving as An Alternative Development of Tourism Concept

Sri Murni, Universitas Sebelas Maret Surakarta, Indonesia

Rahmawati, Universitas Sebelas Maret Surakarta, Indonesia

Sri Wahyu Agustiniingsih, Universitas Veteran Bangun Nusantara, Indonesia

APCMB-0051

Industry 4.0 on Success Factors of Precision Machinery

Wen-Hsiang Lai, Feng Chia University, Taiwan

Chao-Hsuan Chen, Feng Chia University, Taiwan

APCMB-0068

The Effect of Organizational Forms on Real Earnings Management of Taiwan's Nonprofit Hospitals

Yi Chieh Wen, National Taichung University of Science and Technology, Taiwan

Pingsun Huang, National Cheng Kung University, Taiwan

Hsiu-Chu Shen, Kaohsiung Veterans General Hospital & National Sun Yat-sen University, Taiwan

Yan Zhang, State University of New York, USA

ISEPSS-0061

Systemic Function Evaluation based Configurations of a Technological Innovation System for Smart Cities

Chi-Yo Huang, National Taiwan Normal University, Taiwan

Yu-Sheng Kao, The University of Tokyo, Japan

Wei-Ti Huang, National Taiwan Normal University, Taiwan

Li-Wei Yang, National Taiwan Normal University, Taiwan

Yu-Ning Chen, National Taiwan Normal University, Taiwan

Yen-Chu Lin, National Taiwan Normal University, Taiwan

APCMB-0102

Exploration of Students Environmentally Friendly Consumption Behaviour

Arum Darmawati, Yogyakarta State University, Indonesia

Tony Wijaya, Yogyakarta State University, Indonesia

Andreas Kuncoro, Yogyakarta State University, Indonesia

09:00-10:30 | Kaze

Thursday Session I

Education II

Session Chair: Prof. Dorit Maor

ISEPSS-0211

System changing approach to introduce mobile technologies in a hospital school

Dorit Maor, Murdoch University, Australia

ISEPSS-0226

Learning and Teaching Thai Studies to Chinese Students Using Series of Circulating Banknotes Printed

Shuping Feng, Srinakharinwirot University, Thailand

Nition Pornumpaisakul, Srinakharinwirot University, Thailand

ISEPSS-0075

Open plan learning classroom - a practical approach

Penny Round, Monash University, Australia

Pearl Subban, Monash University, Australia

10:45-12:15 | Beni

Thursday Session II

Business & Management IV & Economics I

Session Chair: Prof. Muhammad Taufiq Amir

APCMB-0059

Positive Leadership: A Preliminary Conceptual Clarification

Muhammad Taufiq Amir, Universitas Bakrie, Indonesia

APCMB-0079

Investigating Characteristics of Online Shopping Platform and Impulsive Purchase: The Moderating Roles of Gender and Shopping Experiences

Chia-Han Chang, National Sun Yat-sen University, Taiwan

Ming-Chen Chen, National Sun Yat-sen University, Taiwan

Chien-Yuan Sher, National Sun Yat-sen University, Taiwan

Zhao-Hong Cheng, National Kaohsiung University of Science and Technology, Taiwan

APCMB-0057

Investigating the Contagion Effects of Problematic Smartphone Behaviors

Yu-Kang Lee, National Sun Yat-sen University, Taiwan

Chun-Tuan Chang, National Sun Yat-sen University, Taiwan

You Lin, National Sun Yat-sen University, Taiwan

Chia-Han Chang, National Sun Yat-sen University, Taiwan

Zhao-Hong Cheng, National Kaohsiung University of Science and Technology, Taiwan

ISEPSS-0073

Why the Simple-List Model of Applying Prescription Drug Fee is Popular in the Taiwan National Health Insurance Practices

Ming-Chen Chen, National Sun Yat-sen University, Taiwan

Chien-Yuan Sher, National Sun Yat-sen University, Taiwan

APCMB-0090

*Mechanism Research on the Role of Knowledge Management in SME's
Innovation: A Perspective From Chinese Shandong Province*

Bailu Li, Shandong Polytechnic, China

Weixu Ding, Ritsumeikan University, Japan

10:45-12:15 | Kaze

Thursday Session II

Law, Economics II, Finance

Session Chair: Dr. Ersan Paramita

ISEPSS-0062

Corruption Eradication and Human Rights under International and Administrative Law

Paramita Ersan, University of Padjadjaran, Indonesia

I Gde Pantja Astawa, University of Padjadjaran, Indonesia

Huala Adolf, University of Padjadjaran, Indonesia

APCMB-0077

Top Management Team Heterogeneity and Investment Performance

Chih-Wei Peng, National Changhua University of Education, Taiwan

APCMB-0072

Firm Ownership, Export Types and Export Growth Evidence from China

Chih-Hai Yang, National Central University, Taiwan

Meng-Wen Tsou, National Central University, Taiwan

ISEPSS-0076

The Design Certification Approach to the Policy Economy Assessment - Realignment into the 4th Industrial Revolution Indonesian Case Study

Wijianto, Universitas Airlangga, Indonesia

Mochamad Shamsul Arif, Universitas Airlangga, Indonesia

APCMB-0024

Case Study of Hong Kong Banking System

Kevin Daly, Western Sydney University, Australia

APCMB-0093

Investment Fraud as a Form of Developing Ponzi Scheme in Indonesia, who is most Responsible

Sulihanto Sri Rekno, Universitas Kristen Satya Wacana, Indonesia